



FORTEC<sub>medical</sub>

# OmniGuide<sup>®</sup>

## CO<sub>2</sub> Laser



**Case-by-Case  
MOBILE SERVICE**

CO<sub>2</sub> laser energy delivered via a flexible fiber system exhibits greater surgical precision than monopolar and electrocautery in both cutting and coagulation modes.

Its flexibility and maneuverability provide surgeons with the control to operate near difficult to navigate regions with minimal risk of damaging healthy tissue.

It provides greater dissection capabilities with minimal to no increase in thermal penetration, resulting in significantly less tissue damage.

**Minimal thermal spread to surrounding structures**

**10x less thermal spread than cautery**

**Layer by layer dissection**

**Cutting, coagulation and vaporization in one tool**

**Consistent, predictable tissue interaction**



**Advanced Surgical  
Technologies.**

**Clinical Procedural  
Support.**

**Access for All.**

## Product Features & Specifications

# OmniGuide<sup>®</sup> CO<sub>2</sub> Laser

### ENT Procedures

The Elevate™ ENT System is a fiber and instrumentation solution customized for Head & Neck Surgeons and Laryngologists. The system can access hard-to-reach anatomy with heightened performance and enhanced comfort. Handpieces range from 5cm to 22cm in length. Select fibers are also available.

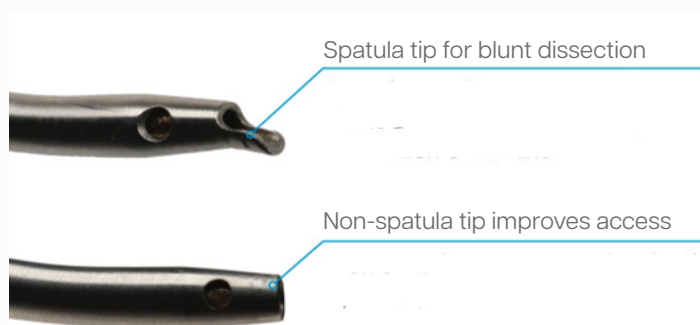

#### Laser Specifications:

**Laser type:** CO<sub>2</sub>

**Power:** Up to 25W

**Wavelength:** 10.6 μm

**Dimensions:** 8" (h) x 19.5" (w) x 19" (d)

### Enhanced Bend Angles



0° Distal Bend



15° Distal Bend



21° Distal Bend



25° Distal Bend



30° Distal Bend

### GYN Procedures

CO<sub>2</sub> delivers precision energy for the complete treatment of endometriosis, adhesiolysis, ovarian cysts and myomas. Maximizes preservation of reproductive tissue.

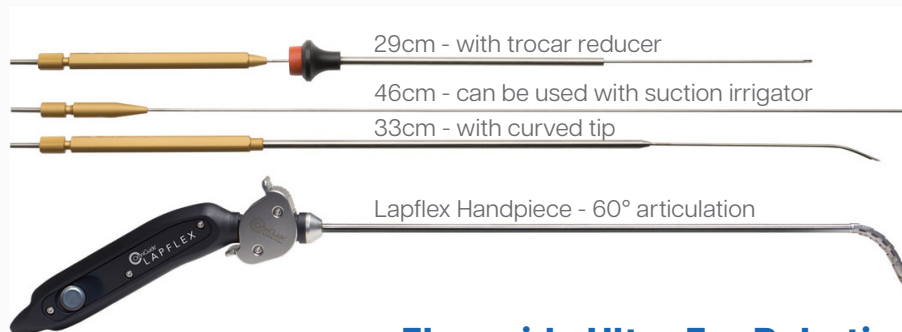

### Flexguide Ultra For Robotic Cases

